

Tissue Expanders

Tissue Expanders

Tissue expanders crescent with integrated magnetic valve

POLYsmooth™

Order N°	Dimensions (mm)				Volume (ml)
	A	B	C	D	
50690-200 ¹	95	60	45	70	200
50690-300 ¹	110	70	60	85	300
50690-400 ¹	125	75	65	95	400
50690-700 ¹	150	90	75	115	700

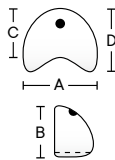

Tissue expanders crescent with remote valve

POLYsmooth™

Order N°	Dimensions (mm)				Volume (ml)
	A	B	C	D	
51690-200	95	60	45	70	200
51690-300	110	70	60	85	300
51690-400	125	75	65	95	400
51690-700	150	90	75	115	700

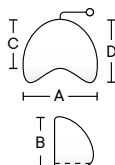

Tissue expanders rectangular with integrated magnetic valve

POLYsmooth™

Order N°	Dimensions (mm)			Volume (ml)	
	A	B	C	Min.	Max.
50680-160 ¹	51	38	110	160	200
50680-200 ¹	50	70	60	200	220
50680-250 ¹	59	50	96	250	280
50680-320 ¹	62	47	141	320	400
50680-400 ¹	55	56	136	400	430
50680-500 ¹	69	51	158	500	540
50680-600 ¹	50	70	180	600	650
50680-700 ¹	50	50	280	700	720
50680-800 ¹	87	57	185	800	960

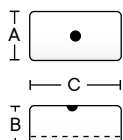

Tissue expanders rectangular with remote valve

POLYsmooth™

Order N°	Dimensions (mm)			Volume (ml)	
	A	B	C	Min.	Max.
51680-050 ¹	38	38	38	50	60
51680-100 ¹	46	53	60	100	130
51680-160	51	38	110	160	200
51680-200	50	70	60	200	220
51680-250	59	50	96	250	280
51680-320	62	47	141	320	400
51680-400	55	56	136	400	430
51680-500	69	51	158	500	540
51680-600	50	70	180	600	650
51680-700 ¹	50	50	280	700	720
51680-800 ¹	87	57	185	800	960

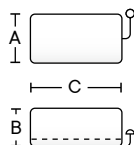

Tissue expanders round with integrated magnetic valve

POLYsmooth™

Order N°	Dimensions (mm)			Volume (ml)
	A	B	C	
50627-200 ¹	96	96	48	200
50627-300 ¹	111	111	54	300
50627-400 ¹	121	121	58	400
50627-500 ¹	131	131	62	500
50627-600 ¹	136	136	64	600

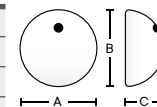

Tissue expanders round with remote valve

POLYsmooth™

Order N°	Dimensions (mm)			Volume (ml)
	A	B	C	
51627-200 ¹	96	96	48	200
51627-300 ¹	111	111	54	300
51627-400 ¹	121	121	58	400
51627-500 ¹	131	131	62	500
51627-600 ¹	136	136	64	600
51627-700 ¹	146	146	68	700
51627-800 ¹	151	151	70	800

